

STANDARD F PSA FIA SD BIOSENSOR

STANDARD F PSA FIA performs quantitative measurement of prostate-specific antigen (PSA) level in serum, plasma and whole blood samples using fluorescence immunochromatography. Through the STANDARD F Analyzer, test results with high sensitivity and specificity can be obtained.



- PSA is a tumor marker for the diagnosis of prostate cancer
- Automatic strip recognition by reading the information stored in 2D barcode
- Reagents can be stored at room temperature: 2-30°C / 36-86°F



Specification	
Specimen Type	Whole blood, Serum, Plasma
Specimen Volume	100µl (Serum, Plasma) / 20µl (Whole blood)
Measurement Range	0.1 – 100 ng/ml (Serum/Plasma) 2 – 100 ng/ml (Whole blood)
Reference Range	≤ 4.0 ng/ml
Testing Time	10 minutes
Storage Conditions	2-30°C / 36-86°F

METHODS OF SAMPLE COLLECTION

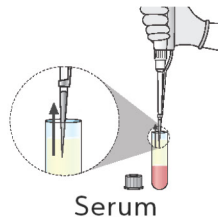

TEST PROCEDURE

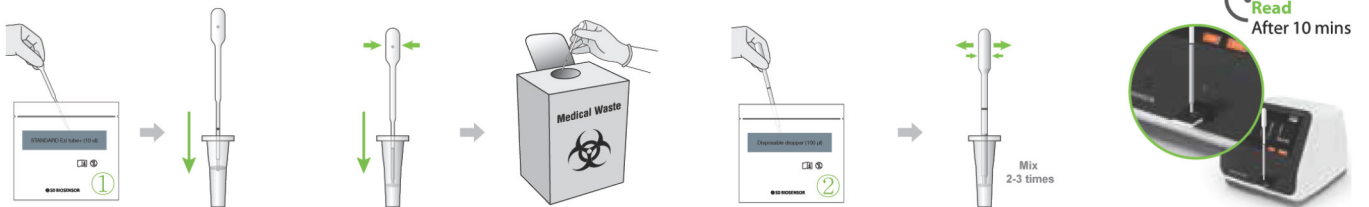

Collect 10 µl of sample with a STANDARD Ezi tube+ (10 µl).

Dispense collected sample into the extraction buffer tube. Then, discard the used STANDARD Ezi tube+ (10 µl).

Mix sample and buffer 2-3 times with the disposable dropper (100 µl). Then collect 100 µl of sample mixture.

Apply the sample mixture into the sample well of the test device and immediately press the start button.

METHOD COMPARISON

Reference Method vs STANDARD F PSA FIA

Correlation vs ECLIA Method	$y=0.9589x - 0.2336, R=0.9948, n=180$
CV%	QCL=9.0% / QCM=8.0% / QCH=7.2%
Differ (%)	Within 15%

ORDERING INFORMATION

Category	Product	Pack Size
Hormone	STANDARD F PSA FIA	20 Test
	STANDARD F PSA Control	Lv1 x 10 / Lv2 x 10